



Newcombe Park

£1,475,000

A characterful and well maintained 4 bedroom property located in a prime residential road in Mill Hill within a stones throw from Mill Hill Broadway.

This wonderful property comprises of a welcoming entrance hallway with parquet flooring, spacious reception room with original fireplace and exposed beams providing plenty of character, dining room, study and a open plan kitchen/breakfast family room, in addition to ample storage and shower room. On the first floor there are 3 spacious double bedrooms and a family bathroom and separate W/C.

Further benefits include original features throughout, Double glazed craft timber made windows kept in line with the original design. A beautiful 120ft garden, potential to extend into the loft and rear STPP, close to amenities and Thames Link Station. Sole Agent, Viewing Highly Recommended.

Viewing

Please contact our Mill Hill Office on 020 8959 0011 if you wish to arrange a viewing appointment for this property or require further information.



4



2



3



D

Floor Plan

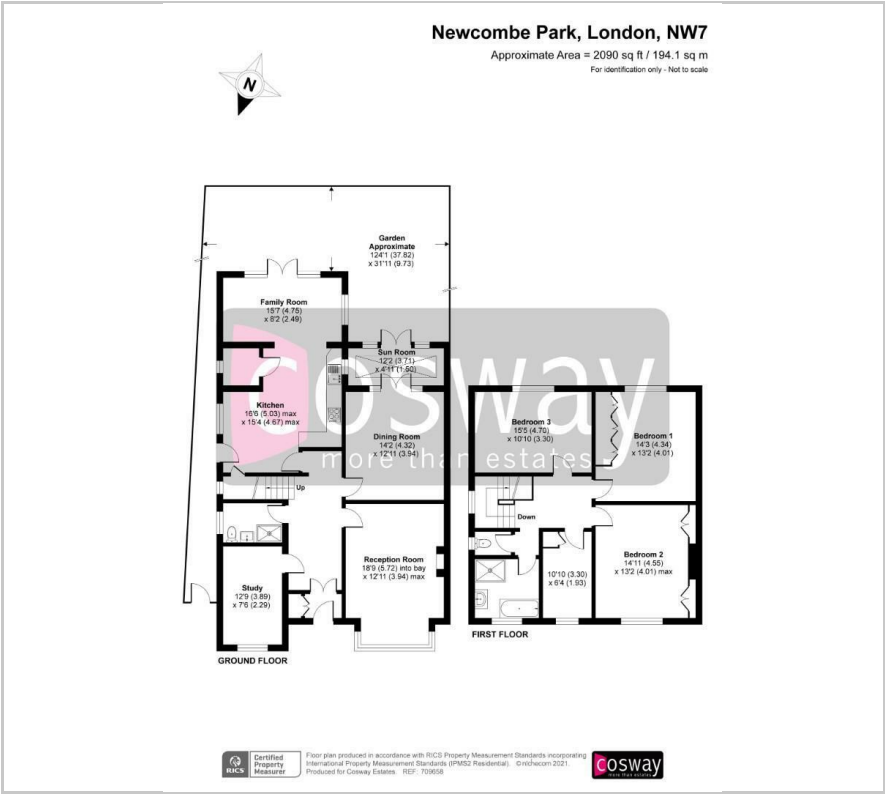

Area Map



Energy Efficiency Graph

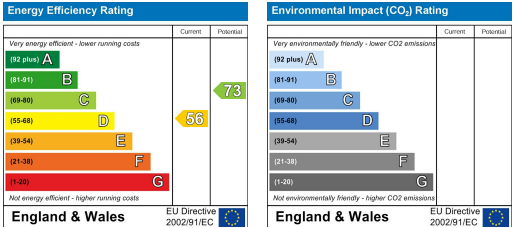

These particulars, whilst believed to be accurate are set out as a general outline only for guidance and do not constitute any part of an offer or contract. Intending purchasers should not rely on them as statements of representation of fact, but must satisfy themselves by inspection or otherwise as to their accuracy. No person in this firms employment has the authority to make or give any representation or warranty in respect of the property.